

**PROSOCO R-GUARD™ Air & Moisture Barrier
with PROSOCO R-GUARD™ “Splice Strip”**

Detail No.: 20.09

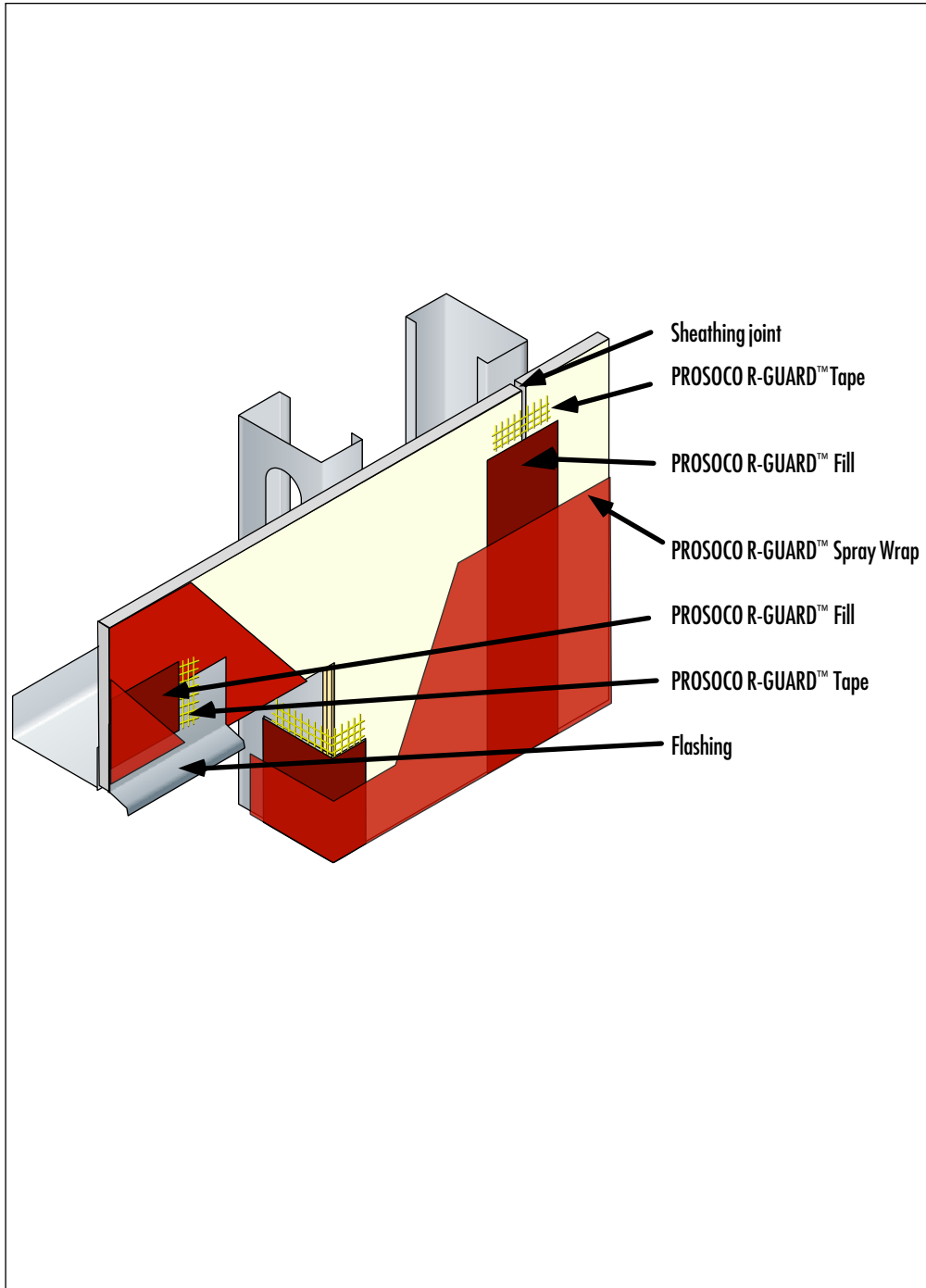

Notes:

- 1] Apply PROSOCO R-GUARD™ Tape over sheathing joints and rough openings and trowel PROSOCO R-GUARD™ Fill over Tape.
- 2] Coat entire surface with PROSOCO R-GUARD™ Spray Wrap.
- 3] Apply PROSOCO R-GUARD™ Tape over head flashing, roof side-wall step flashing and similar conditions and trowel PROSOCO R-GUARD™ Fill over Tape.
- 4] Apply PROSOCO R-GUARD™ Spray Wrap over the splice strip of PROSOCO R-GUARD™ Fill/ Tape.