

**PROSOCO R-GUARD™ Air & Moisture Barrier
Pan Flashing at Opening Sill**

Detail No.: 20.23c

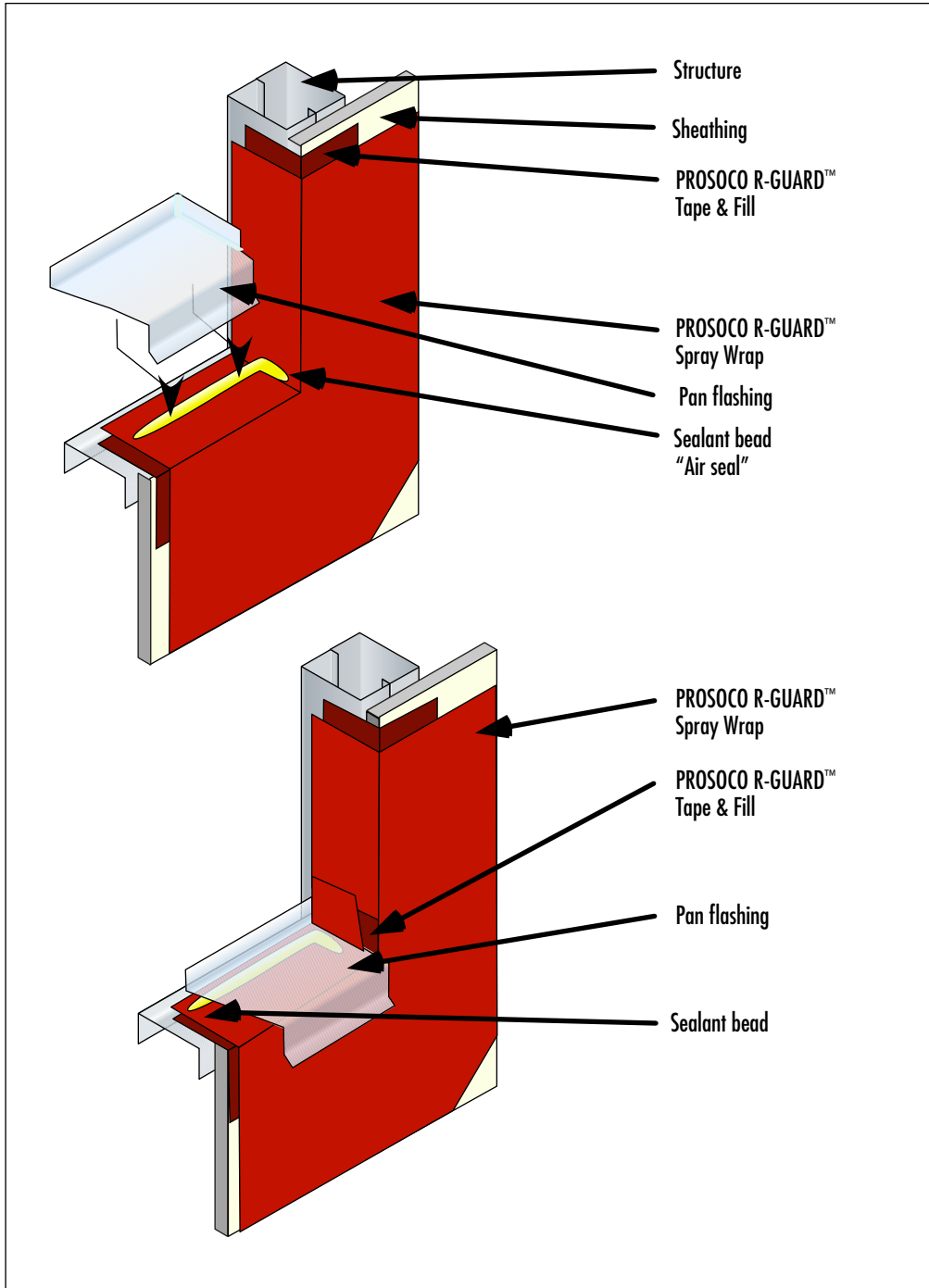

Notes:

- 1] Prepare rough opening as shown in PROSOCO Detail 20.23a and 20.24.
- 2] Install one or more beads of neutral-cure, silicone sealant on the sill and jamb.
- 3] Install the sill pan flashing into the wet sealant and press it into place. Tool any excess sealant off at the top of the side dams and back edge of the pan flashing.
- 4] When installed, the seal between the pan flashing and the rough opening protection must be air tight.
- 5] Install PROSOCO R-GUARD™ Tape & Fill to the end dams so water draining down the jamb will be directed into the pan flashing and out of the wall assembly.