

## PROSOCO R-GUARD™ Air & Moisture Barrier Parapet Termination

Detail No.: 20.60

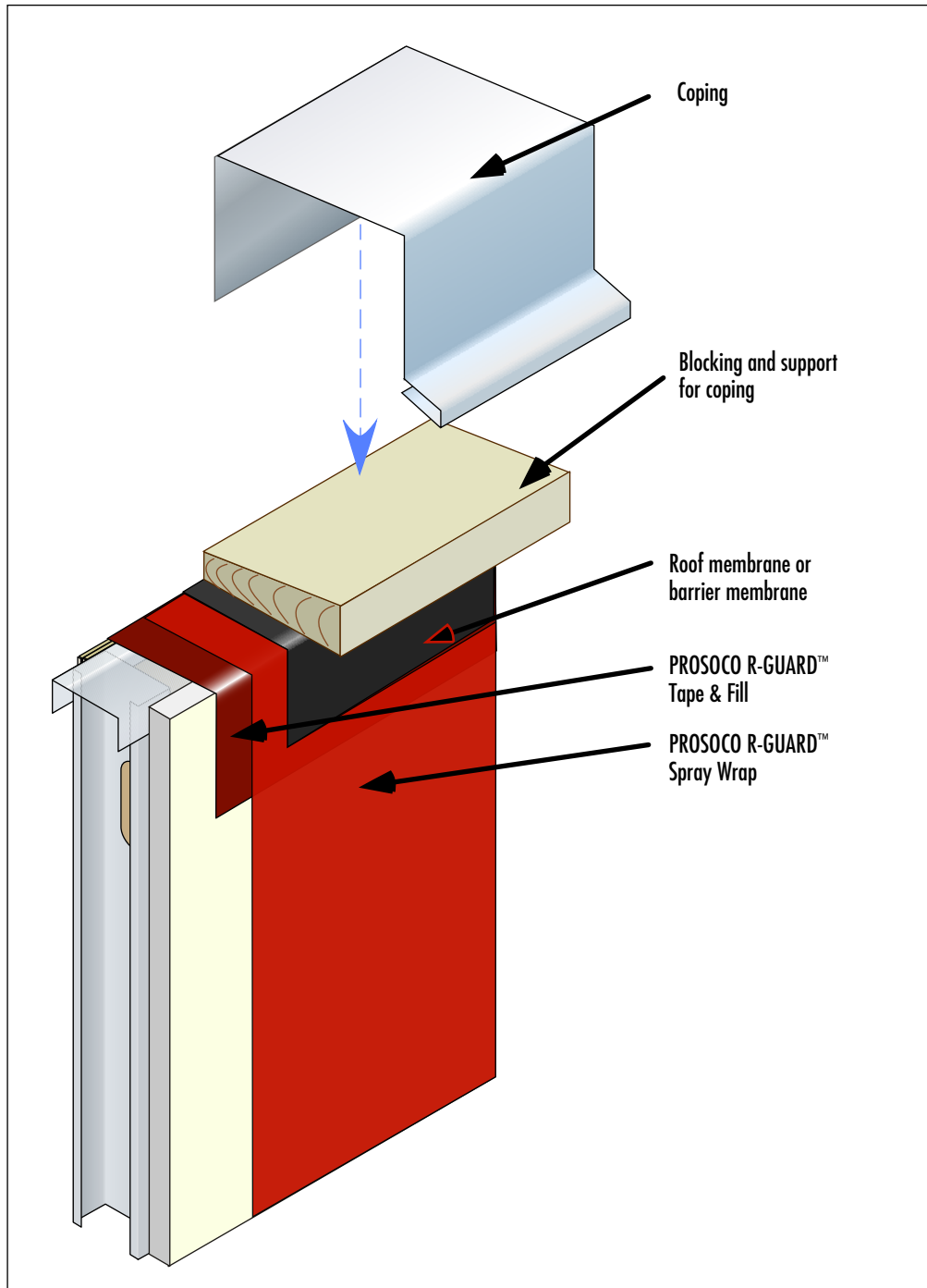

### Notes:

- 1] Install the PROSOCO R-GUARD™ Air & Moisture Barrier to the surface of the wall assembly and over the top of the parapet where possible, and/or wrap roofing membrane over the parapet to lap over PROSOCO R-GUARD™.
- 2] Install a durable coping flashing and support to protect the parapet from water intrusion and to direct water away from the face of the cladding.

**Note:** It may be difficult to isolate the parapet cavity from the conditioned space on the building interior. Air leakage through the parapet can be a source of condensation, especially in cold climates where the stack effect will force warm humid air up into the parapet. The continuity of the air seal at this location is important to maintain.