

## PROSOCO R-GUARD™ Air & Moisture Barrier Preparation through Wall Construction

Detail No.: 20.70

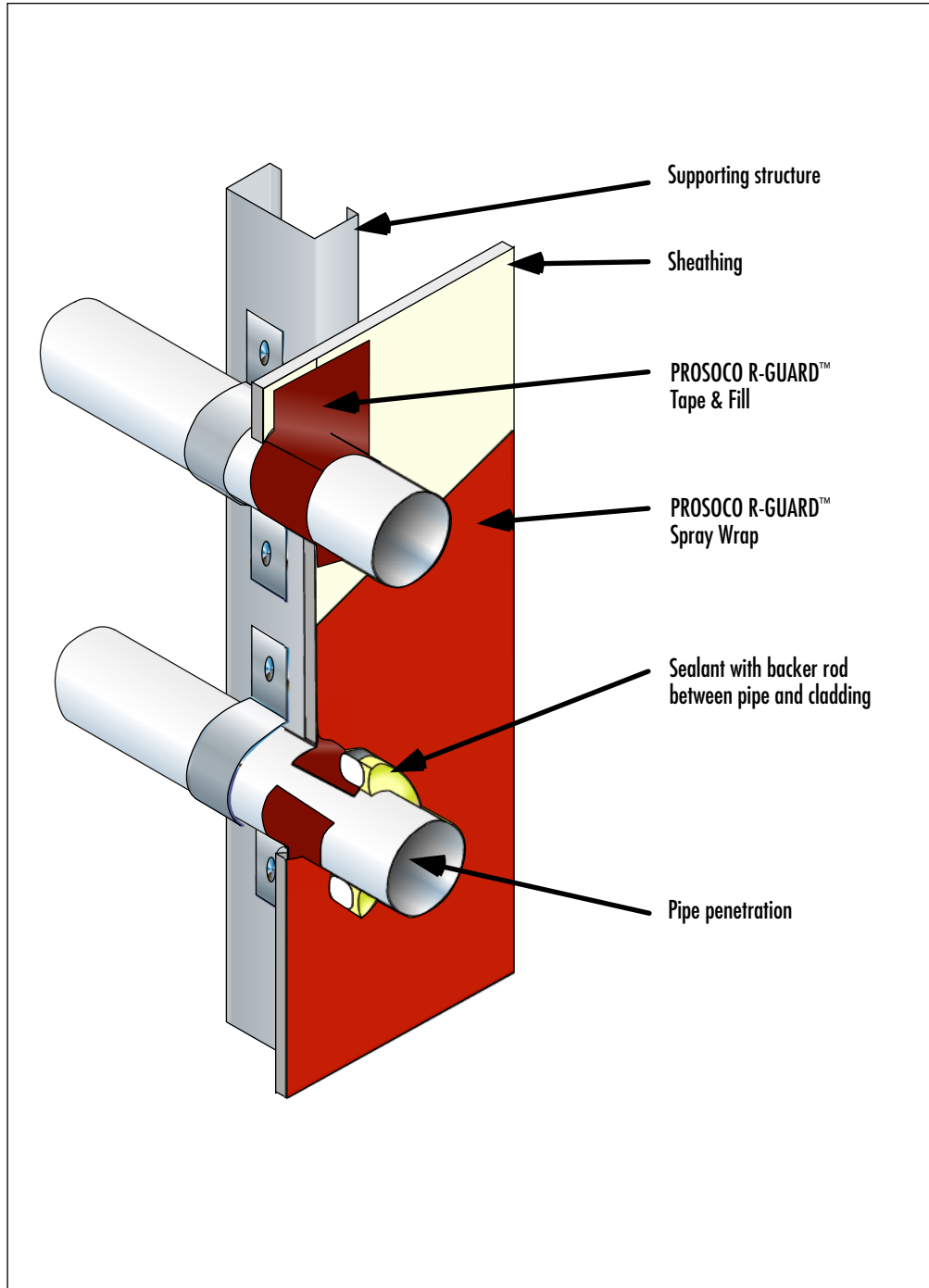

### Notes:

1] Detail assumes pipe is installed prior to the cladding.

2] Provide air seal around the penetration with PROSOCO R-GUARD™ Tape & Fill to reduce air pressure difference across the outer cladding sealant. Refer to PROSOCO Detail 20.09.

Alternate 2] Provide barrier sheet membrane in lieu of PROSOCO R-GUARD™ Fill at penetration where joint between sheathing and penetrating element exceeds 1/8" (3mm). Lap barrier sheet membrane over PROSOCO R-GUARD™ Spray Wrap.

4] Seal cladding to penetrating object.