

**PROSOCO R-GUARD® Air & Water-Resistive Barrier
Wood Frame with Brick Veneer**

Detail No.: 20.00e

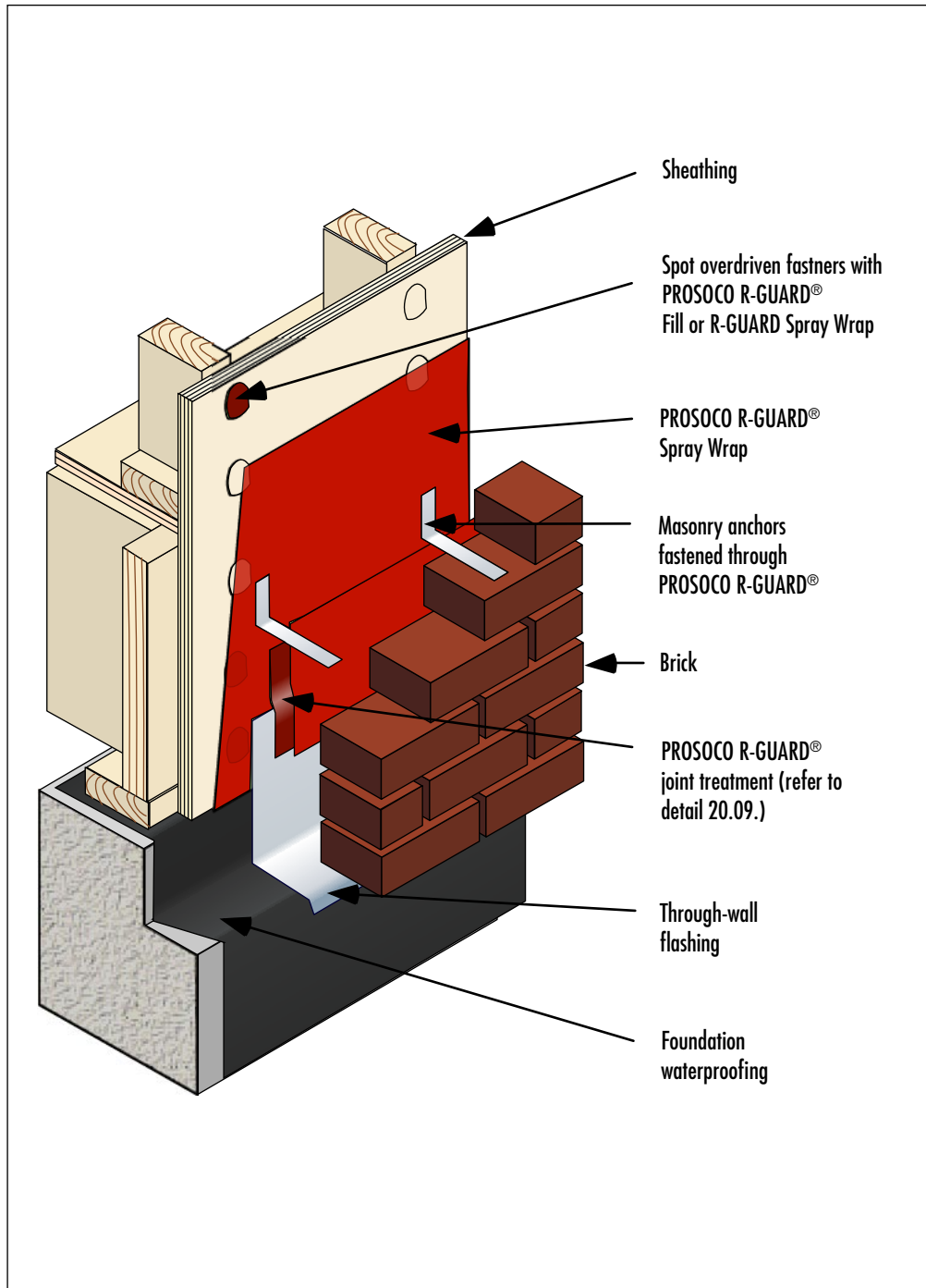

Notes:

This installation shows masonry anchors that are fastened through PROSOCO R-GUARD® Air & Water-Resistive Barrier.

1] Install PROSOCO R-GUARD® as per Product Data Sheet.

2] Install flashing. Integrate the flashing with the PROSOCO R-GUARD® as per PROSOCO Detail 20.09.

3] Secure masonry anchors as per anchor manufacturer's specifications. Refer to PROSOCO Detail 20.03 for alternate installation detail.