

R-Guard®

AIR & WATER BARRIERS

Rough Opening Using Two Products - S4.1B

Sheathing Wall Construction with gypsum, plywood or OSB sheathing.

Apply a thick bead of **Joint & Seam Filler** to all inside corners, joints and seams within the rough opening. Use a dry joint knife or trowel to spread 1 inch beyond the seam on each side to a thickness of 20-30 mils.

Apply a thick bead of **FastFlash** over the framing inside the rough opening and the structural wall surrounding the rough opening. Use a dry joint knife, trowel or chipper brush to spread the wet product to create a seamless flashing membrane which protects the rough opening and extends 4-6 inches over the face of the

structural wall. When using a flanged window, extend **FastFlash** 2 inches beyond the edge of the window flange. Apply additional **FastFlash** as needed to create an opaque, monolithic flashing membrane free of voids or pinholes.

Spray or roller apply the selected R-Guard air and water-resistive barrier over the prepared sheathing. Apply sufficient product to cover the entire face of the structural wall.

When stud framing is used in lieu of track, cover knockout with breakmetal and seal edges with **FastFlash** (see insert below).

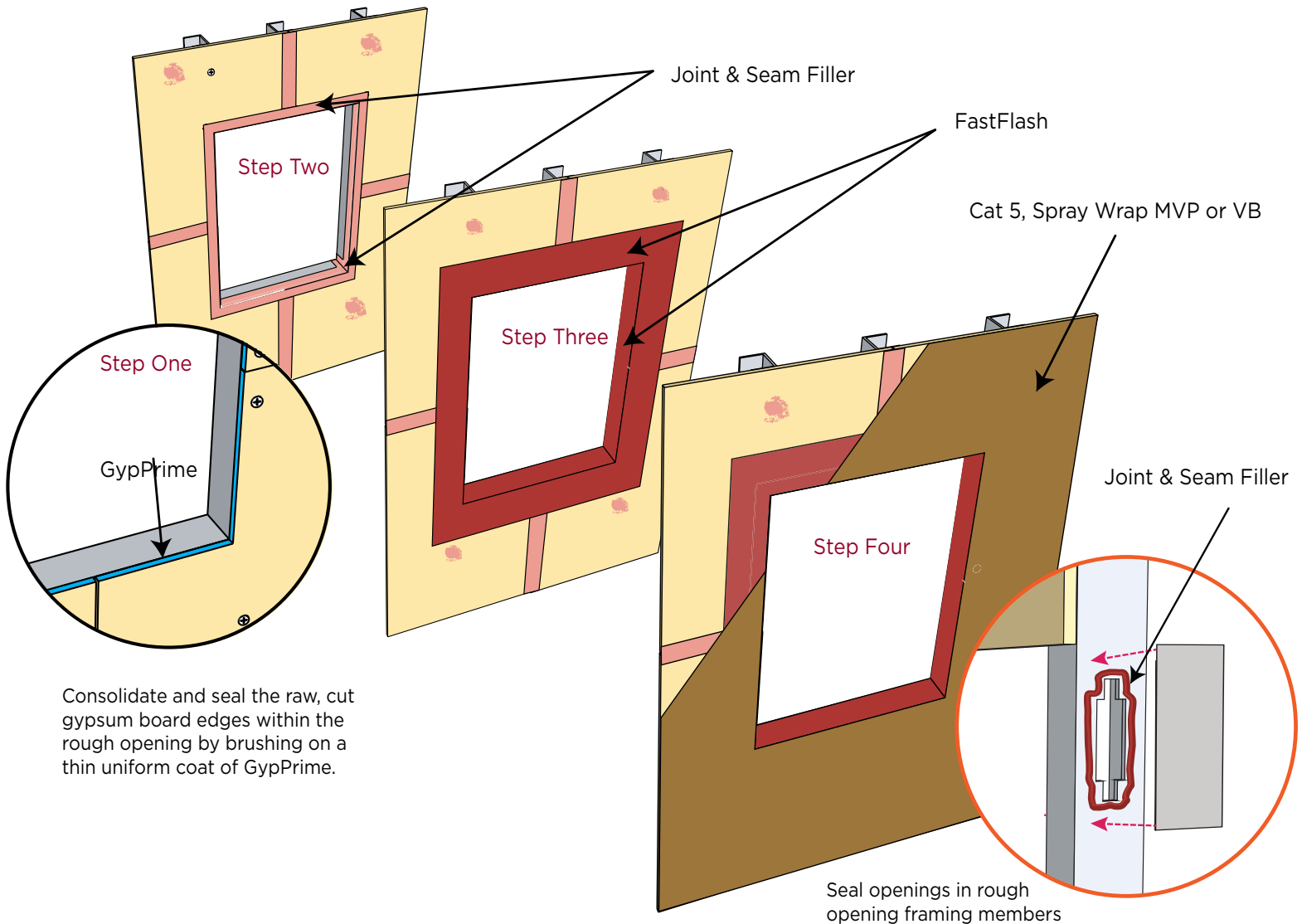

Consolidate and seal the raw, cut gypsum board edges within the rough opening by brushing on a thin uniform coat of GypPrime.