

### SS ThruWall Flashing

R-Guard's prefabricated stainless steel end dams, inside corners, and outside corners are recommended with all of R-Guards flashing products. Made of 26 gauge 304 stainless steel. Spot welded and soldered.

- End Dams: Measure 4" H x 4" D x 4" W
- Inside Corner: Measure 4" H x 6" D x 6" W with a 2" notch
- Outside Corner: 4" H x 6" D x 10" W
- Termination Bar: 1" W x 8' L with top sealant lip, 1/4" holes every 8" \*(24 gauge)
- Drip Edge: 3" W x 8' L, x 1/4" 30 degree hemmed outside edge
- Corners: inside and outside with hemmed outside edges
- Stainless steel weep vents 2.5 x 3.5, 3.5 x 3.5

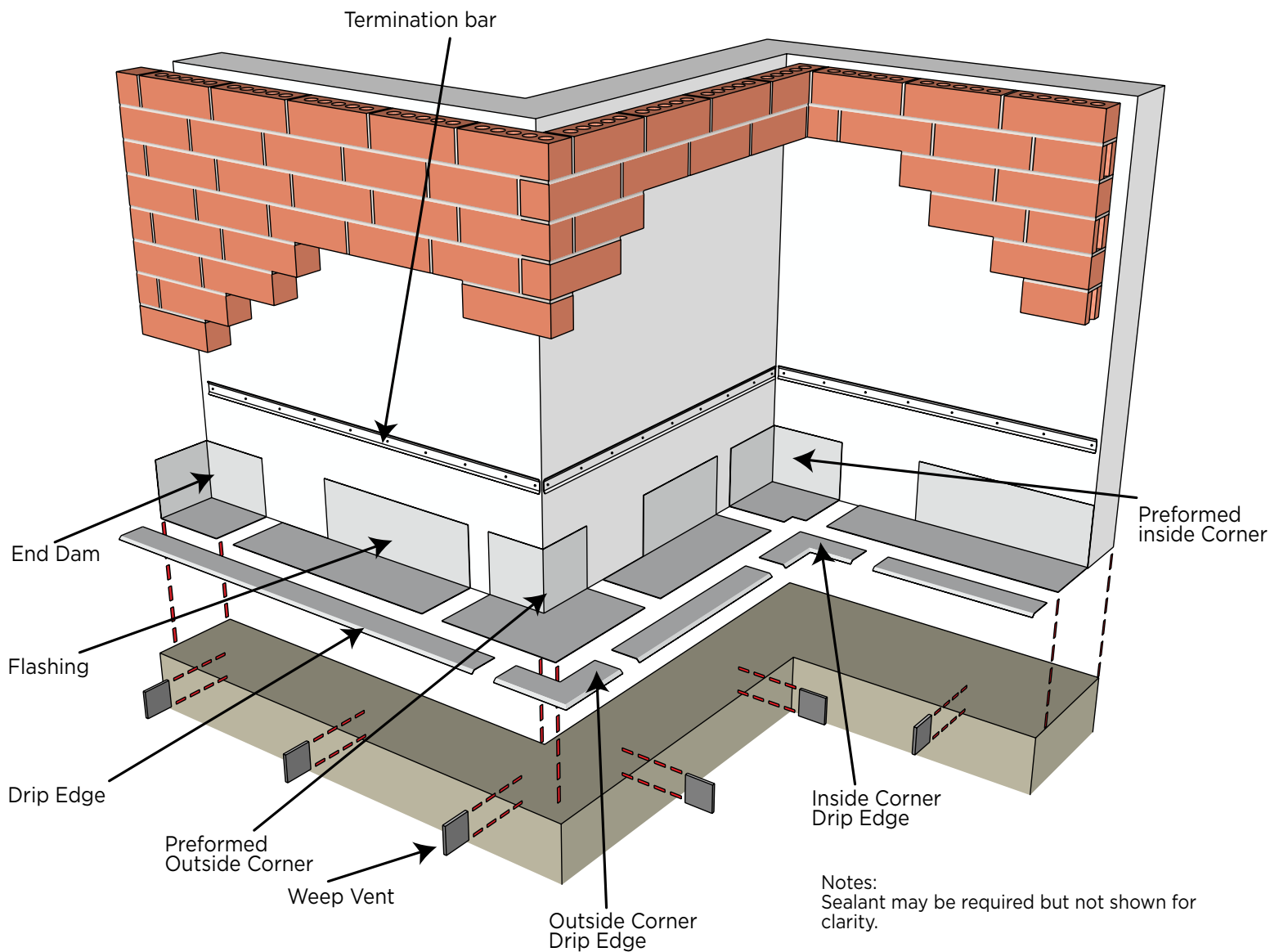

Notes:  
Sealant may be required but not shown for clarity.

Flashing & drip edges shall be continuous.  
Exploded view shows gaps for clarity.